

# Motorized Torque-Arm II Speed Reducer Electric Fans Instruction Manual

These instructions must be read thoroughly before installation or operation. This instruction manual was accurate at the time of printing. Please see [dodgeindustrial.com](http://dodgeindustrial.com) for updated instruction manuals.

**WARNING:** Only qualified electrical personnel familiar with the construction and operation of this equipment and the hazards involved should install, adjust, operate, and/or service this equipment. Read and understand this manual in its entirety before proceeding. Failure to observe this precaution could result in severe bodily injury or loss of life.

**WARNING:** All products over 25 kg (55 lbs) are noted on the shipping package. Proper lifting practices are required for these products.

## INSTALLATION

1. Mount gearmotor assembly before installing the electric fan kit.
2. Remove the fan assembly and corresponding parts from the packing material. Verify and identify all components and fasteners shown in the relevant graphic below. (Figure 1 applies to MTA 7 and 8 installations, and Figure 2 applies to MTA 9, 10, and 12.)
3. If the reducer is to be mounted in position D, plumb a drain line from the drain hole to one side of the reducer and ensure the drain line aligns with the slot in the fan shroud per Figure 3. Break the tab off the shroud plate at the scored line for the drain line.
4. If the reducer is to be mounted in position D, locate where water or other liquids can accumulate in the fan panel. Drill maximum 1/4" diameter drain holes in the corners of the fan panel for proper drainage before installation.
5. Center the panel fan on the fan shroud mounting face and assemble using the specified fasteners.
6. Place the fan-shroud assembly on the reducer and assemble using the appropriate fasteners. Note that for MTA 7 and 8, the fan shroud mounts to the reducer using the reducer flange bolts; for MTA 9, 10, and 12 the shroud mounts to dedicated mounting pads.

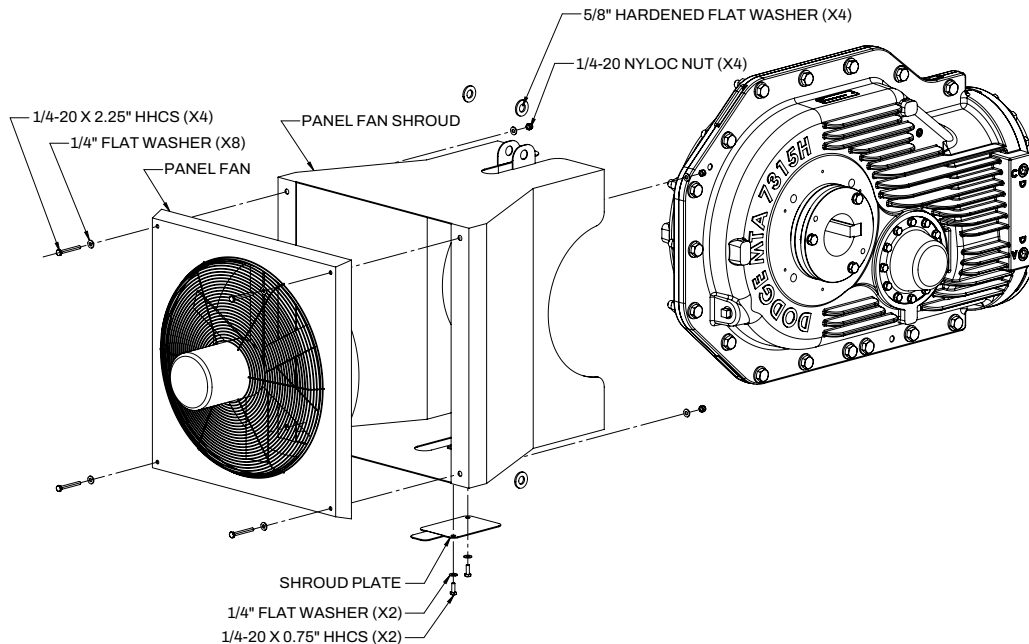
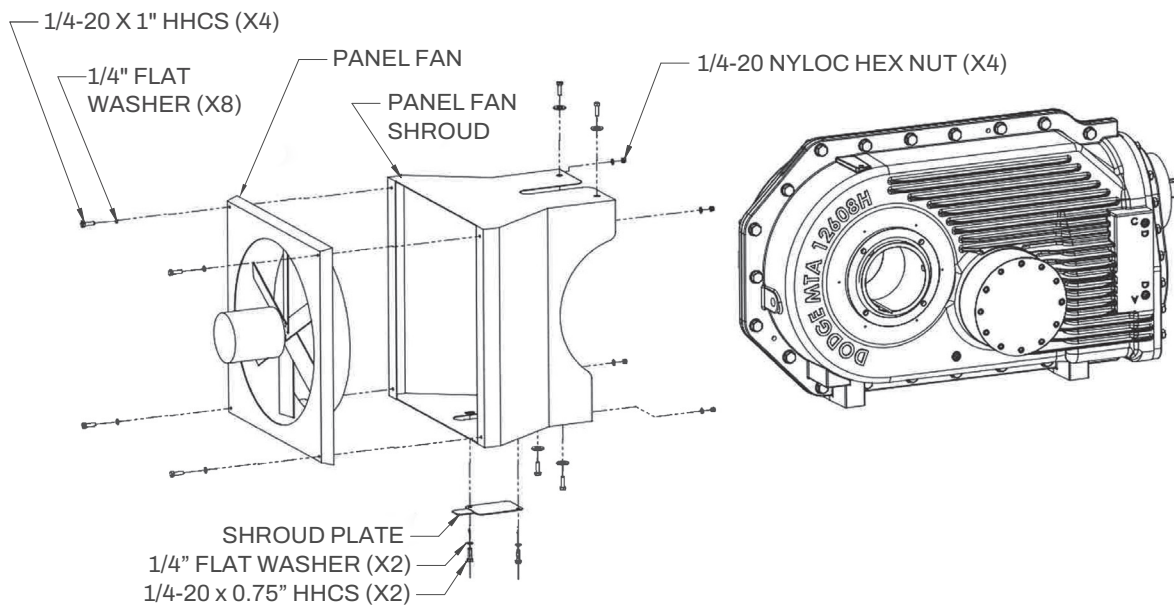
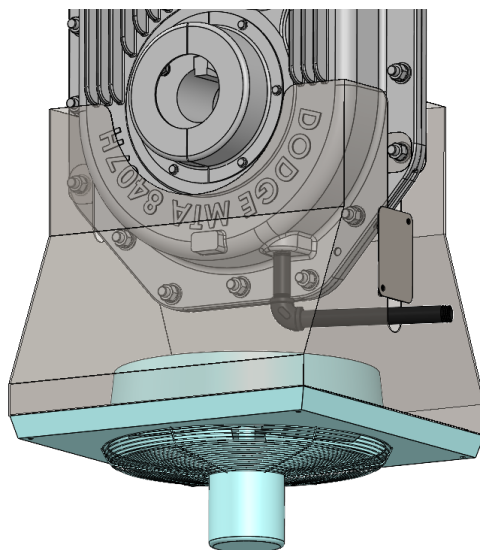

Figure 1 - Electric Fan Assembly (MTA Sizes 7 & 8)

**WARNING:** Because of the possible danger to person(s) or property from accidents which may result from the improper use of products, it is important that correct procedures be followed. Products must be used in accordance with the engineering information specified in the catalog. Proper installation, maintenance and operation procedures must be observed. The instructions in the instruction manuals must be followed. Inspections should be made as necessary to assure safe operation under prevailing conditions. Proper guards and other suitable safety devices or procedures as may be desirable or as may be specified in safety codes should be provided, and are neither provided by Dodge® nor are the responsibility of Dodge. This unit and its associated equipment must be installed, adjusted and maintained by qualified personnel who are familiar with the construction and operation of all equipment in the system and the potential hazards involved. When risk to persons or property may be involved, a holding device must be an integral part of the driven equipment beyond the speed reducer output shaft.



**Figure 2 - Electric Fan Assembly (MTA Sizes 9, 10, & 12)**



**Figure 3 - Drain Line Plumbing**

## WIRING OF ELECTRIC FAN

Use the electrical diagram below for wiring the electric motor.

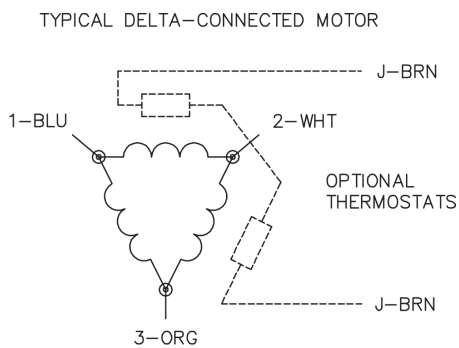
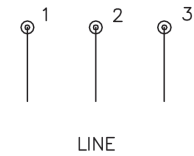
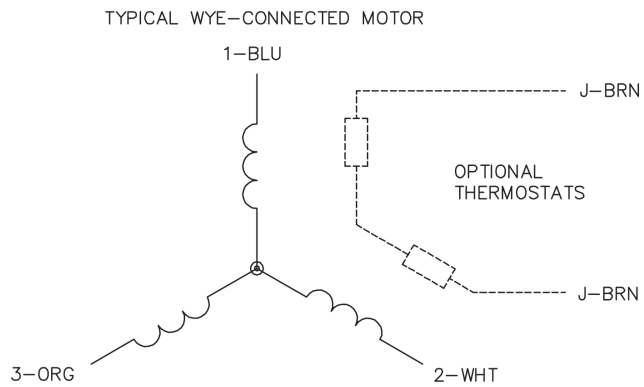

### NOTES:

1. THREE LEAD MOTOR MAY BE EITHER WYE CONNECTED OR DELTA CONNECTED.
2. INTERCHANGE ANY TWO LINE LEADS TO REVERSE ROTATION.
3. OPTIONAL THERMOSTATS ARE PROVIDED WHEN SPECIFIED.
4. ACTUAL NUMBER OF INTERNAL PARALLEL CIRCUITS MAY VARY.
5. LEAD COLORS ARE OPTIONAL. LEADS MUST BE NUMBERED AS SHOWN.

**Dodge Industrial, Inc.**  
1061 Holland Road  
Simpsonville, SC 29681  
+1 864 297 4800

© DODGE INDUSTRIAL, INC.  
AN RBC BEARINGS COMPANY



All Rights Reserved. Printed in USA.  
MN1703 REV- 06/24