

Reliability Kits

Enhance gearbox performance

For gearboxes operating under extreme conditions, reliability kits enhance durability and longevity—ensuring consistent performance and maximum uptime for critical equipment while reducing maintenance needs. Additionally, reliability kits allow for remote oil level checks of a running gearbox, contributing to a safer working environment.

Motorized Torque-Arm (MTA)

Creates a closed-loop system that eliminates the introduction of any outside air or contaminants.

Torque-Arm II (TA II), TXT®, MagnaGear XTR®, and Maxum® XTR

Creates a semi-closed-loop system that eliminates the introduction of unfiltered outside air or contaminants.

1. Large, vented oil sight tube with custom-length, closed-loop hose
2. Quick drain valve
3. Oil sampling valve
4. ABS bushing covers, closed and split (not shown; MTA, TXT, TA II only)
5. Quick connect fill valve (Maxum and MagnaGear only)
6. Enclosed breather (MTA)
7. Hydra-Lock desiccant breather or OPTIFY™ Breather (except MTA)
8. OPTIFY Performance Sensor port (sensor sold separately)

Note: Kits differ by gearbox type. Review individual product images below to determine which of the above numbered components are included with each kit.

MagnaGear XTR

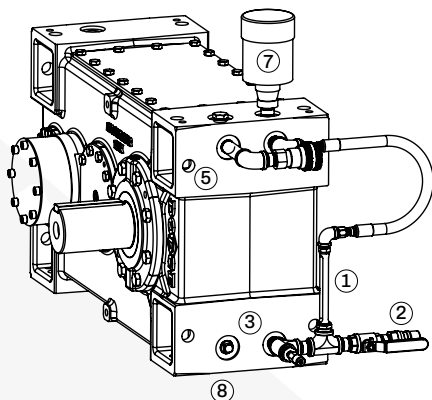

Maxum XTR

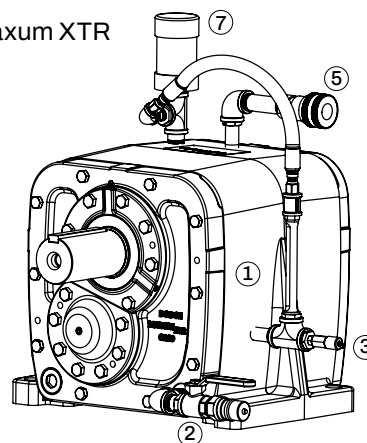

MTA

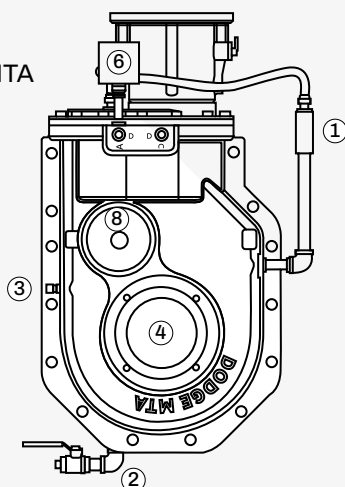

TA II

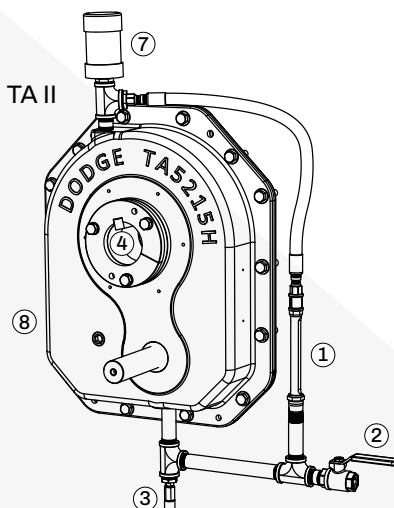

TXT

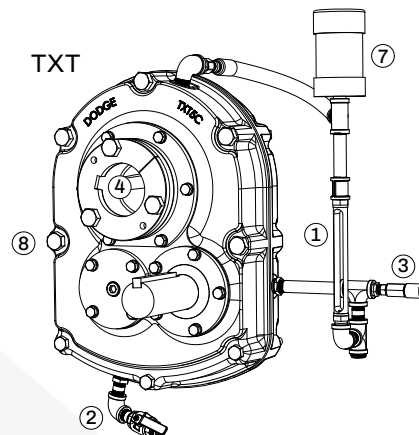

Reliability kit part numbers

Reliability kits contain the parts needed for the most common installation configurations and mounting positions, which are listed in the tables below. If you're using a different setup, you may need extra fittings that are not included in the kit.

MTA*

Gearbox description	Enclosed breather option
MTA2115	MTA2RELKIT
MTA3203	MTA3RELKIT
MTA4207	MTA4RELKIT
MTA5215	MTA5RELKIT
MTA6307	MTA6RELKIT
MTA7315	MTA7RELKIT
MTA8407	MTA8RELKIT
MTA9415	MTA9RELKIT
MTA10507	MTA10RELKIT
MTA12608	MTA12RELKIT

* Kits for MTA sizes 2—8 are for position D, and sizes 9—12 are for position C. Position C is the preferred mounting for MTA, regardless of size. Rear-rangement or additional fittings may be required when using kits in alternate positions.

TXT (position B)

Gearbox description	Hydra-Lock breather option	OPTIFY Breather option
TXT5	TXT5RELKIT	TXT5RELKIT-OB
TXT6	TXT6RELKIT	TXT6RELKIT-OB
TXT7	TXT7RELKIT	TXT7RELKIT-OB
TXT8	TXT8RELKIT	TXT8RELKIT-OB
TXT9	TXT9RELKIT	TXT9RELKIT-OB
TXT10	TXT10RELKIT	TXT10RELKIT-OB
TXT12	TXT12RELKIT	TXT12RELKIT-OB

TA II (position B)

Gearbox description	Hydra-Lock breather option	OPTIFY Breather option
TA4207	TA4RELKIT	TA4RELKIT-OB
TA5215	TA5RELKIT	TA5RELKIT-OB
TA6307	TA6RELKIT	TA6RELKIT-OB
TA7315	TA7RELKIT	TA7RELKIT-OB
TA8407	TA8RELKIT	TA8RELKIT-OB
TA9415	TA9RELKIT	TA9RELKIT-OB
TA10507	TA10RELKIT	TA10RELKIT-OB
TA12607	TA12RELKIT	TA12RELKIT-OB

Maxum XTR (horizontal position)

Gearbox description	Hydra-Lock breather option	OPTIFY Breather option
CR50		
CR60	CR50-80RELKIT	CR50-80RELKIT-OB
CR70		
CR80		
CR90		
CR100		
CR110	CR90-130RELKIT	CR90-130RELKIT-OB
CR120		
CR130		

MagnaGear XTR (horizontal position*)

Gearbox description	Hydra-Lock breather option	OPTIFY Breather option
G100	G100RELKIT	G100RELKIT-OB
G150	G150RELKIT	G150RELKIT-OB
G210	G210RELKIT	G210RELKIT-OB
G285	G285RELKIT	G285RELKIT-OB
G390	G390RELKIT	G390RELKIT-OB
G525	G525RELKIT	G525RELKIT-OB
G600	G600RELKIT	G600RELKIT-OB
G700	G700RELKIT	G700RELKIT-OB
G920	G920RELKIT	G920RELKIT-OB

* Parallel and right-angle

Connect with OPTIFY Breathers

Further enhance gearbox reliability with our OPTIFY Breather. It is the next generation of desiccant breather, allowing you to tap into the power of the OPTIFY condition monitoring platform to remotely monitor breather status.

The OPTIFY Breather provides precise measurement of asset-specific data, from rate and direction of saturation to battery life and airflow temperature, indicating when it's time for breather replacement.

